

Chloe 6737 Structural Stone | Air A18 Massage Series

Product Number: CHA18J6737CDFS 67" x 37" x 22"



STANDARD & OPTIONAL ACCESSORIES

JETS: 18 Total

- X 18 EZ Clean HTT Air Jets

PUMPS

- 1.25 Air Power Variable Speed, Pulse & Wave Heated Air Pump
- Remote only

CONTROLS

- Remote Control only

PURITY

- HydroCleanse

DRAINS & OVERFLOWS INFORMATION

- Overflow: Integral Slotted in bath
- Bath Drain: Pop up - White, Biscuit, Black, Polished Chrome, Brushed Nickel, Polished Nickel, Oil Rubbed Bronze
- In Floor Drain EZ Fast Connect (optional)

FAUCET INFORMATION

- Floor mount only (not included)
- Floor mount verify spout distance

STANDARD ACCESSORIES

- Deluxe Cushion Pillow • FDA Recipe Non-Toxic Food & Beverage Grade Plumbing (primarily) • 30 Point Quality Assurance Factory Test



TECHNICAL SPECIFICATIONS

Center drain.

Pump Location: Remote up to 15' away from bath

ELECTRICAL REQUIREMENTS

(1) 115v 20AMP GFCI Circuits

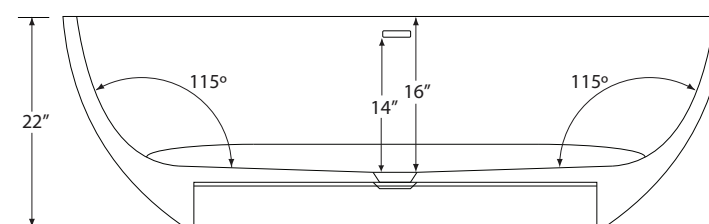
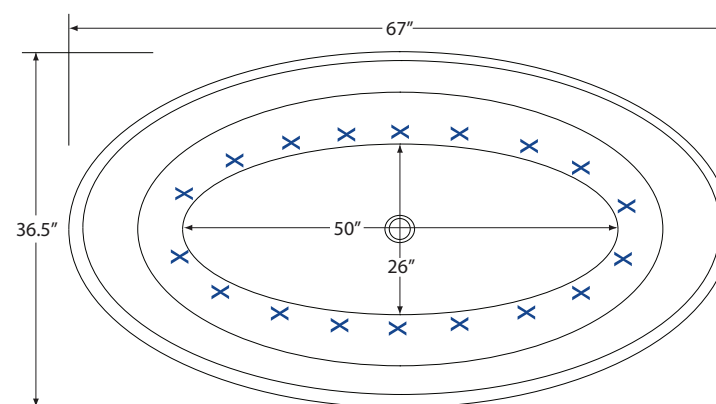

Specifications and features are subject to change without notice and are + .25". All final measurements should be taken from tub on site.
HydroMassage Products LLC • 303-341-1845 • Fax: 303-342-1850 • www.hydromassageproducts.com